

1200 W. EVANS AVENUE

DENVER, COLORADO

Gruber Commercial Real Estate Services | 209 Kalamath Street, #7 Denver, CO 80223 | Tel: 720-320-0366



Retail Showroom/Warehouse For Lease

AVAILABLE SPACE: 7,261 SF

PROPERTY HIGHLIGHTS

- Free-standing building
- One-half mile west of Santa Fe Drive on Evans Avenue
- Fenced storage yard
- One drive-in door
- Great street signage on hard corner with traffic light
- Traffic: 36,848 vehicles/day along W. Evans Avenue

LEASE RATE:
\$9.50/SF NNN

Steve Fletcher, CCIM

Industrial Specialist

Cell: (720) 320-0366

steve@grubercre.com

Gruber

Commercial Real Estate Services

<https://grubercommercial.com>

1200 W. EVANS AVENUE

DENVER, COLORADO

Gruber Commercial Real Estate Services | 209 Kalamath Street, #7 Denver, CO 80223 | Tel: 720-320-0366

FLOOR PLAN

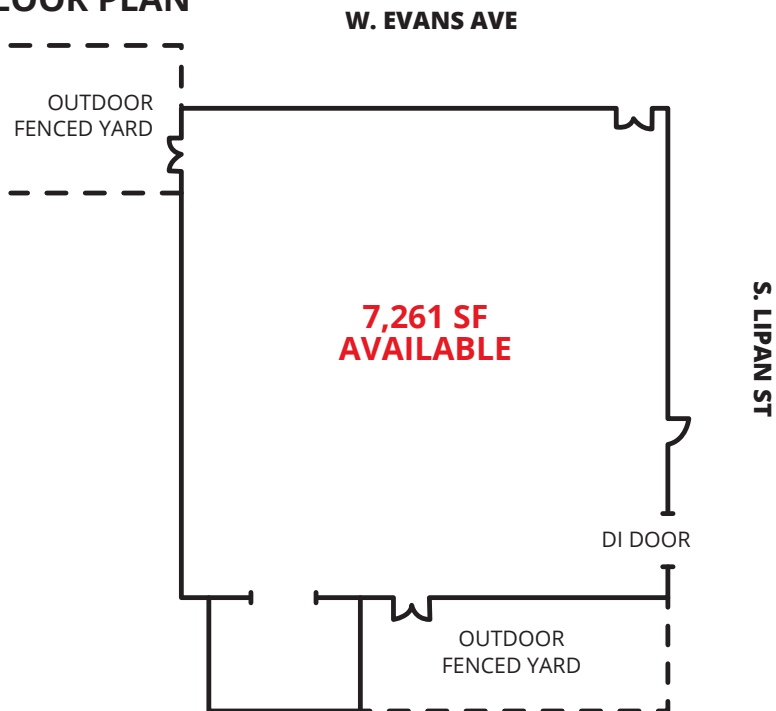

PROPERTY DETAILS

- Available Space: 7,261 SF
- Building Size: 7,261 SF
- Taxes: \$1.98/SF
- Insurance: \$0.30/SF
- Water/Sewer & Storm: \$0.25/SF
- Lot Size: 23,141 SF (0.5 acres)
- Parking: 20 spaces (2.75:1,000 SF)
- Drive-In Door: 1 (8'x10')
- YOC: 1966
- Zoning: I-A

AERIAL



Steve Fletcher, CCIM

Industrial Specialist

Cell: (720) 320-0366

steve@grubercre.com



Commercial Real Estate Services

<https://grubercommercial.com>

The information above has been obtained from sources believed reliable. While we do not doubt its accuracy, we have not verified it and make no guarantee, warranty or representation about it. It is your responsibility to independently confirm its accuracy and completeness. Any projections, opinions, assumptions or estimates used are for example only and do not represent the current or future performance of the property. The value of this transaction to you depends on tax and other factors which should be evaluated by your tax, financial and legal advisors. You and your advisors should conduct a careful, independent investigation of the property to determine to your satisfaction the suitability of the property for your needs. Gruber Commercial Real Estate Services.